



DYS-52

Hydraulic Hawser Winch

The DYS-52 is a high-performance, single-drum hydraulic hawser winch with automatic Render/Recover capabilities, adjustable tension and line scope (length) set-points. Constant tension control permits full hands-free operation, with active line-tension monitoring during all winch activities.

Winch System Specifications

◆ Max. Drum Capacity:	750 feet / 229 meters of 11" circumference / 90 mm diameter synthetic line
◆ Rated Performance:	39,500 lbs / 176 kN (continuous) rating / max line-speed of 338 ft/min / 103 m/min
◆ Max Freewheel Speed:	1000+ ft/min / 305 m/min
◆ Hydraulic Motor & Drive:	Radial piston hydraulic motor. 65 GPM / 246 LPM @ 2700 PSI / 186 Bar
◆ Winch Braking:	Pneumatically controlled drum band brake, pneumatic set and release. Mid-drum brake holding capacity of 815,000 lbs / 3625 kN minimum
◆ Winch Control:	Wheelhouse controls with on-deck emergency stop and freewheel pushbuttons. Line tension display available at all times whether operating the brake or the drive
◆ Weight:	28,000 lbs / 12700 kg



Markey Machinery Company, Inc.

7266 8th Avenue South, Seattle, WA 98108

Ph: (206) 622-4697 Toll Free: (800) 637-3430 Fax: (206) 623-9839

Email: info@markeymachinery.com

Represented by:

Griffin & Associates

355 Grow Avenue NW, Bainbridge Island, WA 98110 (USA)

Ph: (206) 595-9507 Email: bagriffin@griffinassociates.com



ISO 9001:2008 QMS

Represented by:

JH Menge & Company, Inc.

5825 Plouche Street, Harahan, LA 70123 (USA)

Ph: (504) 733-4871 Email: fcilatour@jhmenge.com

Markey DYS-52 Winch

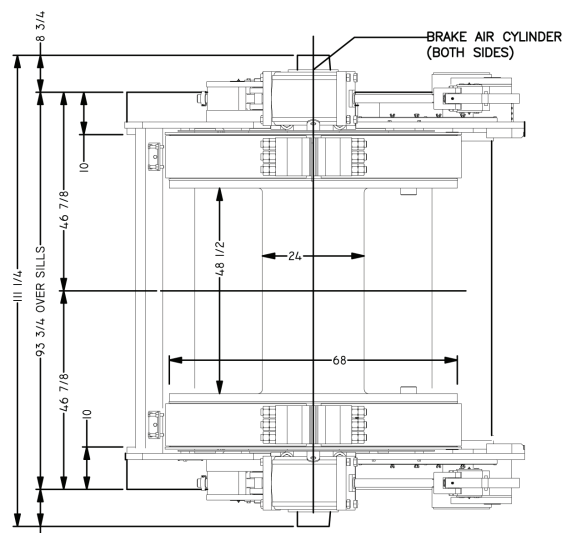
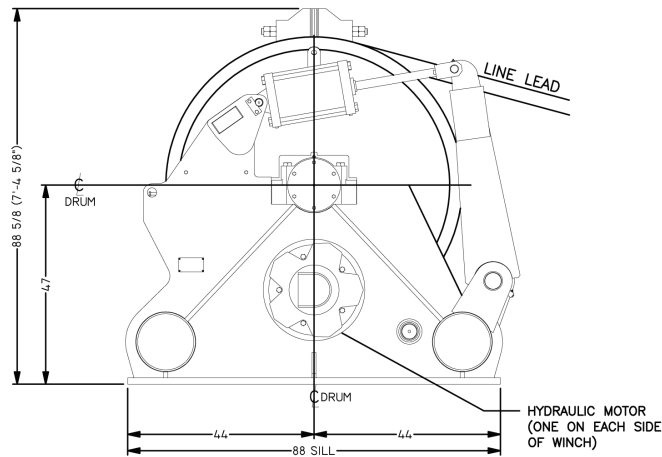

Hawser Winch System Options

- ◆ Digital/Analog Line Tension Display System
- ◆ Multiple Station Controls
- ◆ Performance ratings can be tailored to suit specific applications
- ◆ Other drum options are available

Markey's rugged winches are built to the highest quality workboat standards using materials and processes providing maximum life and minimum maintenance in marine and outdoor applications.

© 2011 MMCo 19595

